

MovinCool® Climate Pro® K Series

# MovinCool Climate Pro K63



## FAMILY FEATURES

- Sleek, modern design
- Wrap around bumper system protects against scratches & dents
- Built-in exhaust flanges with protective grille
- Built-in condensate pump standard
- Convenient cord storage cubby on rear of unit
- Connectivity enabled

## PERFORMANCE

Ambient Operating Range	<b>65-105°F</b>
Cooling Capacity	<b>60,000 Btu/h</b>
Supply Airflow h/m/l cfm	<b>1770/1710/1650</b>
Max Supply/Cold Duct Length	<b>40 feet</b>
Exhaust Airflow h/m/l cfm	<b>2400 (h)</b>
Max Hot/Exhaust Duct Length	<b>100 feet</b>
Sound Level High (w/out duct)	<b>71 dB</b>

## APPLICATION

Voltage @ 60Hz	<b>460</b>
Recommended Breaker Size (A)	<b>20</b>
Amps (A)	<b>12.2</b>
Min/Max Voltage	<b>440-480</b>
Power Cord Gauge	<b>12AWG-4 Core</b>
Power Cord Length	<b>6 feet</b>
Plug Receptacle Requirement 	<b>NEMA L16-20</b>

## SHIPPING/LOGISTICS/ HANDLING/QUALITY

	Shipping	Out of Carton
Weight (lbs.)	743	659
Height (in.)	69	64
Width (in.)	34	31
Depth (in.)	59	55

RoHS Restriction of Hazardous Substances Standard compliant  
UL 60335 and UL 60335-2-40 compliant

# MovinCool Climate Pro K63

## ACCESSORIES

### NOZZLE APPLICATION

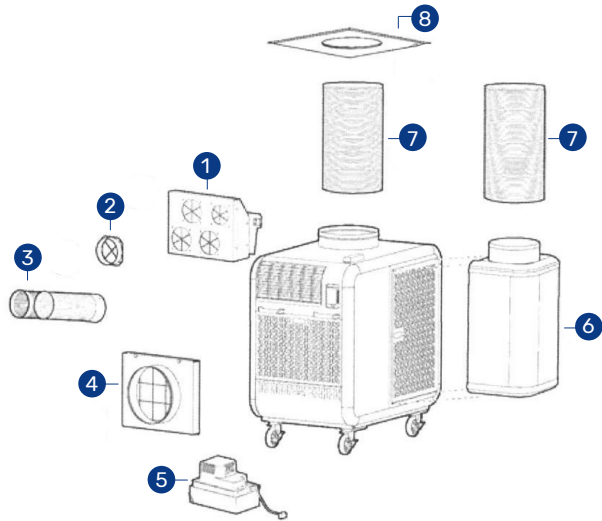

#	Part No.	Description
1	481769-0290	6" Base, Four Hole
2	481170-0490	6" Quick Connect Flange**
3	484209-0490	6" Nozzle**
4	484350-1210	Plenum Evaporator Air
5	484789-0240	Condensate Pump Kit, 230v
6	484350-1240	Plenum Condenser Air
7	LAY45820-0010	Flexible Air Duct, 8' by 16"
8	484490-1040	Ceiling Tile Kit, 16-in hole, metal
*	HDK-16	2' x 2' Ceiling Tile with 7' of 16" Flex Duct

\* Not Pictured

\*\* Sold Individually

### DUCT HOSE APPLICATION

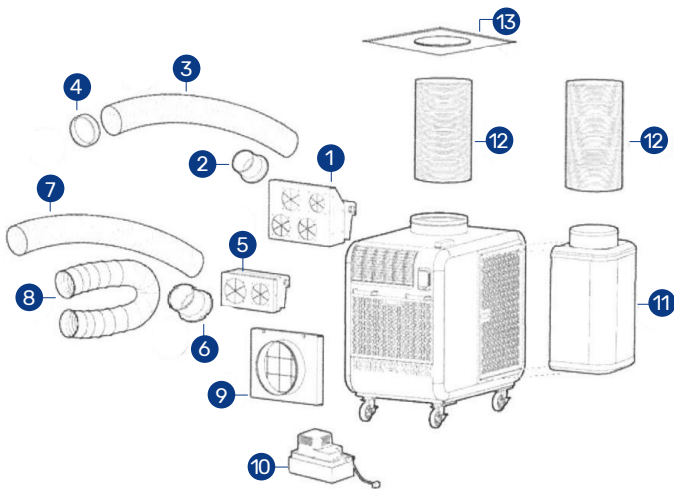

#	Part No.	Description
1	481769-0290	6" Base, Four Hole
2	481170-0460	6" Flange Ext. Duct
3	481744-0030	6" Self-Supported Duct**
4	481851-0210	6" Trim Ring**
5	481769-0300	8" Base, Two Hole
6	481170-0470	8" Flange Ext. Duct
7	LA481744-0430	8" Self-Supported Duct**
8	LAY45810-0030	8" Flexible Air Duct**
9	484350-1210	Plenum Evaporator Air
10	484789-0240	Condensate Pump Kit, 230v
11	484350-1240	Plenum Condenser Air
12	LAY45820-0010	Flexible Air Duct, 8' by 16"
13	484490-1040	Ceiling Tile Kit, 16-in hole, metal
*	HDK-16	2' x 2' Ceiling Tile with 7' of 16" Flex Duct

\* Not Pictured

\*\* Sold Individually